

Deconta C5000A Decontamination Trailer

The Deconta C5000A Decontamination Trailer complete with diesel water system and integrated batteries allows the use of all loads without external power.

Deconta C5000A Decontamination Trailer Features

- Frame construction aluminium
- wall material with double-sided coating
- chassis design steel galvanized
- Tandem-chassis rubber mounted
- overrun brake and hand brake
- 2 extractable stairs
- Diesel water heating and room heating via 4 kW WEBASTO - Diesel warm water generator. An integrated battery allows the use of all loads without external power connection (self-contained operation, when connected to 230 Volt battery is automatically charged).
- Central operation via smart touch Display, LED-lighting with motion detector, coat hooks, 230 V power plug, mirror, lockable storage compartments, lockable
- external door, anti-slip aluminium-flooring
- Negative pressure unit
- Spare wheel incl. holder, lifting jack, nut spanner
- External door self-closing
- Integrated Batteries allows the use of all loads without external power. Max run time 13 hours. **A 2.5Kva generator is needed to recharge the batteries. For best results the generator should be used at all time while the decontamination trailer is in use and not connected to mains power. NOT SUPPLIED BY ASSURED EQUIPMENT SERVICES.**

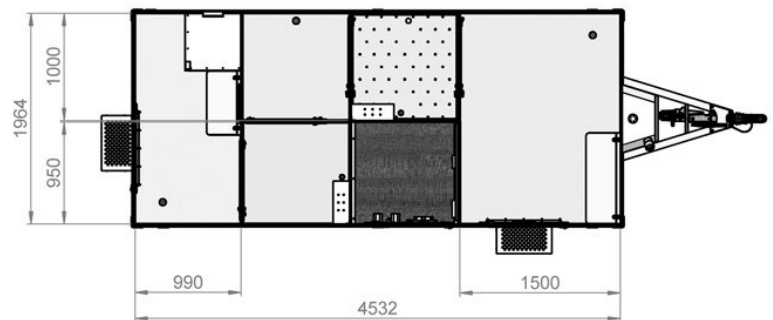

Recommended Spares



- 25 Micron Sediment Filters \$10.95inc each – Requires 2 per trailer
- 5 Micron Sediment Filters \$10.95inc each – Requires 2 per trailer



- Pleat Filter for Negative Pressure Unit \$12.10inc each – Requires 1 Per trailer